



***Red Devil***

**ADHESIVES, SEALANTS,  
PATCH & REPAIR  
PRODUCTS**





**F**ounded as Smith & Hemenway Company, Inc. in 1872 in Hill, New Hampshire, our place in hardware history was established with production of several types of glasscutters, including the patented “Woodward Wizard”. This unique tool, with its tiny wheel for scoring glass was among the first in the industry and could be used as a glass breaker, can opener, corkscrew, knife/scissor sharpener and tack hammer. Because of the “Woodward Wizard” and other unique and dependable tools, our reputation for quality and reliability grew. During a buying trip to Sweden, the company’s founder, Landon P. Smith, heard a blacksmith remark “those little red devils” after sparks from a forge singed his arm. The name stuck in Smith’s mind and upon his return to the States he began to label many of the tools he sold with the RED DEVIL® trade name. By the late 19th century, do-it-yourselfers as well as professionals were depending on our top-performing products.

In the early 1900s, the RED DEVIL® name became synonymous with quality tools for professional and DIY projects. In 1932, George L. Lee, Sr. acquired the Vesco Tools Company’s line of wood scrapers - the first of nearly three dozen acquisitions designed to expand and improve the RED DEVIL® line. These acquisitions included complementary lines of painters’ tools, including wall scrapers, putty knives, glaziers’ diamond points and automatic point drivers. Throughout the years, RED DEVIL® continued to provide new alternatives for age-old problems, developing many innovative products like the ERGO 2000™ PRO putty knife and scraper line, one of the first on the market designed with ergonomic grip handles. In 1963, under the direction of George L. Lee, Jr., RED DEVIL® acquired the Schalk Chemical Company adding a line of adhesives, cleaners and sealants to its growing family of products. This chemical line would become a major contributor to our business and lead us to pioneer innovative, new products such as ONETIME® Lightweight Spackling, the first lightweight spackling on the market and LIFETIME® Adhesive Sealant, the first siliconized acrylic sealant guaranteed to last as long as you own your home.

Today, we build America’s most asked for tools and chemical products: RED DEVIL®, Inc. is still a privately owned, family business with state-of-the-art manufacturing facilities in Pryor, Oklahoma. We’re the only manufacturer to offer such a broad and diversified line of hand tools and chemical products for professional and home maintenance and improvement - more than 400 different products in all. In addition to producing caulks, sealants and tools under our own brand name, we also manufacture private label products for some of the nation’s largest hardware and home center chains. We are still building on our reputation for quality, dependability and innovation - guaranteeing that America’s latest generation of professional contractors and do-it-yourselfers will continue to depend on RED DEVIL® products.





# **Table of Contents: Adhesives, Sealants, Patch & Repair**

## **CUSTOMER SERVICE**

Please call our Customer Service Department for order placement, deliveries, billing inquiries and authorization to return materials.

Toll Free: 1.800.4A.DEVIL  
(1.800.423.3845)  
Phone: 918.825.5744  
Fax: 918.825.5761  
E-mail: [info@reddevil.com](mailto:info@reddevil.com)  
Website: [www.reddevil.com](http://www.reddevil.com)

## **CORRESPONDENCE**

Mail correspondence and confirming purchase orders to:  
Red Devil, Inc.  
Attn: Customer Service  
4175 Webb Street  
Pryor, OK 74361

## **CORPORATE OFFICE**

1437 S. Boulder Ave.  
Suite 750  
Tulsa, OK 74119  
Phone: 918.585.8111  
Fax: 918.585.8120

## **MINIMUM QUANTITIES**

All items will be shipped in full shelf-pack quantities only. Orders received for quantities other than the standard pack multiples will be increased to the next higher standard pack.

## **SUPPLEMENTAL PRICE LISTS**

For a copy of a current price list and conditions of sale, please contact your sales representative or the Customer Service Department.

## **MSDS REQUESTS**

To obtain an MSDS for any Red Devil product, please visit our web site at [www.reddevil.com](http://www.reddevil.com) or call the Customer Service Department.

## ***Caulks & Sealants - Multi-Purpose***

**2-5**

ColorCure® • LIFETIME® Ultra • KING KAULK® •  
LIFETIME® Window, Door & Trim • 100% Silicone •  
Window & Door • LIFETIME®

## ***Caulks & Sealants - Kitchen & Bath***

**6-7**

DuraGuard™ • Silicone Shield • Kitchen & Bath Stain Block™ •  
Caulk Strips • Kitchen & Bath Silicone • Kitchen & Bath EZ Caulk

## ***Adhesives/Sealants - Industrial/Contractor***

**8-11**

RDI • Firestop • HVAC/R • Duct Sealant • Construction Adhesives

## ***Caulks & Sealants - Specialty***

**12-16**

Polyurethane • Foam & Fill® • ZIP-A-WAY® • RD3000™ •  
Glazing Compound • Masonry & Concrete • Clear Caulk •  
Gutter & Foundation • Blacktop & Roof • Fireplace & Stove •  
CREATE-A-COLOR®

## ***Tile Products***

**17**

Tile Grout • Tile Adhesive

## ***Patch & Repair Products***

**18-19**

ONETIME® • LIGHTEN UP™ • Vinyl Spackling •  
Wallpaper Seam Repair • Crack Patch™ • Concrete Patch •  
Joint Compound • Stucco Wall Patch • Patch & Prime™

## ***Cleaning & Maintenance Products***

**20**

SAV-A-BRUSH® • TSP 90® • Tack Cloth

# Multi-Purpose Products

The Red Devil® line contains many multi-purpose caulks to choose from: premium sealants that contain a material to fight mildew growth, advanced caulks that provide excellent flexibility and durability, and quality painter's caulks that help save time and energy.

## COLORCURE® PINK 2 WHITE ADVANCED SEALANT

ColorCure® Pink 2 White Advanced Acrylic Sealant is a premium, multi-purpose sealant formulated to provide a dry time indicator. This unique sealant is solvent-free, plasticizer-free and low VOC. The sealant goes on pink but dries white indicating when it is ready to paint and provides the maximum level of durability on a variety of substrates indoors or outdoors. It offers superior paintability and includes HomeShield™ Antimicrobial Protection to ensure against the worst types of mold and mildew.

0576 - 9.5 Fl. Oz. (280 mL) - White

0585 - 5 Fl. Oz. (147 mL) - White

Meets or exceeds ASTM C834 requirements.

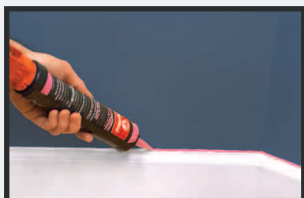

***Goes On Pink, Dries White***  
***When It's Ready to Paint***



## 100% SILICONE SEALANT

Long-lasting formula gives tight, weather-resistant seals to glass, metal, and ceramic surfaces. Will not crack, shrink, or peel. Can be applied at temperatures below freezing. 50 year limited warranty. Interior/exterior use. Solvent clean-up.

- 0810 - 2.8 Fl. Oz. (83 mL) - White
- 0816 - 9.0 Fl. Oz. (266 mL) - White
- 0816/40 - 9.0 Fl. Oz. (266 mL) - Bronze
- 0816/50 - 9.0 Fl. Oz. (266 mL) - Gray
- 0816/60 - 9.0 Fl. Oz. (266 mL) - Black
- 0820 - 2.8 Fl. Oz. (83 mL) - Clear
- 0826 - 9.0 Fl. Oz. (266 mL) - Clear

Meets or exceeds performance requirements of Fed. Spec. TT-S-00230C, TT-S 001543A, ASTM C920. Appropriate for use in federally inspected meat and poultry plants.



## LIFETIME® WINDOW, DOOR & TRIM ADVANCED SEALANT

LIFETIME® Window, Door & Trim Advanced Sealant is a high performance, multi-purpose caulk formulated to last for the lifetime of your home. This unique formulation provides the maximum level of adhesion to a variety of substrates indoors or outdoors. It offers excellent paintability and includes HomeShield™ Antimicrobial Protection to ensure against the worst types of mold and mildew.

- 0856PR - 10.1 Fl. Oz. (300 mL) - White
- 0866PR - 10.1 Fl. Oz. (300 mL) - Clear

Meets ASTM C920 Class 12.5 requirements.



## LIFETIME® ULTRA PREMIUM ACRYLIC SEALANT

LIFETIME® Ultra Premium Elastomeric Acrylic Latex Sealant is a high performance, multi-purpose sealant formulated to last for the lifetime of your home. This unique formulation provides the maximum level of durability on a variety of substrates indoors or outdoors. It offers excellent paintability and includes HomeShield™ Antimicrobial Protection to ensure against the worst types of mold and mildew.

- 0770 - 10.1 Fl. Oz. (300 mL) - White
- 0770/10 - 10.1 Fl. Oz. (300 mL) - Tan
- 0770/20 - 10.1 Fl. Oz. (300 mL) - Almond
- 0770/40 - 10.1 Fl. Oz. (300 mL) - Brown
- 0770/50 - 10.1 Fl. Oz. (300 mL) - Gray
- 0770/60 - 10.1 Fl. Oz. (300 mL) - Black
- 0775 - 5.5 Fl. Oz. (160 mL) - White
- 0777 - 10.1 Fl. Oz. (300 mL) - Clear

Meets or exceeds ASTM C920 Class 25 requirements.





# Multi-Purpose Products

## KING KAULK® HYBRID POLYMER

KING KAULK® Hybrid Polymer is an amazing product you're sure to go ape over! It's so powerful that one tube replaces all your caulks, sealants and adhesives making it the one step solution for almost every repair project. One tube replaces silicone sealant, construction adhesive, kitchen & bath sealant and panel adhesive. Won't shrink or crack, UV/weather resistant, excellent paintability, low-VOC.

0956 - 9.0 Fl. Oz. (290 mL) - White

0966 - 9.8 Fl. Oz. (290 mL) - Clear



## QUICKPAINT® CAULK

A styrenated, siliconized, acrylic caulk specially formulated for the paint contractor that's paintable in just 30 minutes! Higher solids reduce shrinkage. Adheres to most surfaces. 40 year limited warranty. Interior/ exterior use. Water clean up.

0946 - 10.1 Fl. Oz. (300 mL) - White

Exceeds the requirements of ASTM C834.



## PAINTER'S CAULK

An acrylic latex caulk designed for easy paintability. It provides tight, waterproof seals and can be used on most common construction surfaces. Takes all types of paint when dry. 25 year warranty. Interior/exterior use. Water clean up.

0746 - 10.1 Fl. Oz. (300 mL) - White

Exceeds the requirements of ASTM C834.



## SPEED DEMON® ACRYLIC CAULK

General purpose, economical caulk for use on masonry, painted and unpainted wood. Interior/ exterior use. Water clean up.

0736 - 10.1 Fl. Oz. (300 mL) - White



## EZ SQUEEZE® WINDOW & DOOR CAULK

Formulated to provide an extra-tight seal around windows, doors and other areas of your home, this multi-purpose sealant can be used indoors or outdoors and helps increase energy efficiency by reducing drafts and cold spots. The patented EZ SQUEEZE® Device allows you to wind up the tube as you work, ensuring a steady supply of product that comes out smoothly and easily down to the last drop. Mildew-resistant, paintable, water clean up.



0848 - 5 Fl. Oz. (150 mL) - White

## 35 YR. WINDOW & DOOR SILICONIZED ACRYLIC CAULK

Advanced siliconized acrylic formula helps increase energy efficiency by reducing drafts and cold spots. It also provides a barrier to the entry of dirt, insects and adheres to most surfaces. Interior/exterior use. 35 year limited warranty. Water clean up.



0846 - 10.1 Fl. Oz. (300 mL) - White

0846/20 - 10.1 Fl. Oz. (300 mL) - Almond

0846/30 - 10.1 Fl. Oz. (300 mL) - Cedar

0846/40 - 10.1 Fl. Oz. (300 mL) - Dk. Brown

0846/50 - 10.1 Fl. Oz. (300 mL) - Gray

0846/60 - 10.1 Fl. Oz. (300 mL) - Black

0876 - 10.1 Fl. Oz. (300 mL) - Clear

Meets or exceeds ASTM C834 requirements (except Clear).



## LIFETIME® SILICONIZED ACRYLIC ADHESIVE SEALANT

The first caulk guaranteed to last as long as you own your home! LIFETIME® Siliconized Acrylic Adhesive Sealant includes Home Shield™ Antimicrobial Protection to ensure against the worst types of mold and mildew. This high performance, multi-purpose sealant helps increase your home's energy efficiency while decreasing your heating and cooling costs. It provides the maximum level of adhesion to a variety of substrates, offers excellent paintability and cleans up easily with water.



0856 - 10.1 Fl. Oz. - White

0856/60 - 10.1 Fl. Oz. - Black

0856/20 - 10.1 Fl. Oz. - Almond

0866 - 10.1 Fl. Oz. - Ultra Clear

0856/30 - 10.1 Fl. Oz. - Cedar

0855 - 5.5 Fl. Oz. - White

0856/40 - 10.1 Fl. Oz. - Dk. Brown

0865 - 5.5 Fl. Oz. - Ultra Clear

0856/50 - 10.1 Fl. Oz. - Gray



Meets requirements of Fed. Spec. TT-S-0230C (except Clear).  
Also meets ASTM C920 and ASTM C834.

**Caulks & Sealants - Multi-Purpose**



# Kitchen & Bath

Caulks & Sealants - Kitchen & Bath

## SILICONE SHIELD™ KITCHEN & BATH SEALANT

Silicone Shield™ Kitchen & Bath is a premium, quality spec-compliant sealant formulated for kitchen and bath applications that can be exposed to water in 1 hour. Won't crack, shrink or peel, excellent adhesion, permanently flexible, mold and mildew resistant.

0816KB - 9.0 Fl. Oz. (266 mL) - White

0826KB - 9.0 Fl. Oz. (266 mL) - Clear

Meets or exceeds performance requirements of Fed. Spec. TT-S-00230C, TT-S 001543A, ASTM C920.

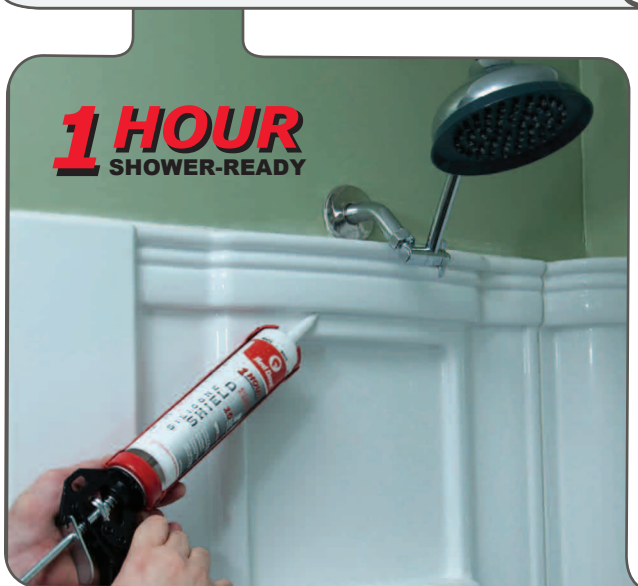

## KITCHEN & BATH STAIN BLOCK™ SEALANT

Red Devil's Kitchen & Bath with Stain Block™ is specially formulated to resist the toughest stains: red wine/grape juice, coffee, mustard, ketchup, soy sauce, etc. This advanced sealant can be painted with latex and oil-based paints, and cleans up with water. Cured bead is mold and mildew resistant.

0750 - 10.1 Fl. Oz. (300 mL) - White

0750/22 - 10.1 Fl. Oz. (300 mL) - Biscuit

0755 - 5.5 Fl. Oz. (160 mL) - White

0755/22 - 5.5 Fl. Oz. (160 mL) - Biscuit

0757 - 10.1 Fl. Oz. (300 mL) - Clear

0765 - 5.5 Fl. Oz. (160 mL) - Clear





## KITCHEN & BATH LOW ODOR SILICONE SEALANT

An advanced, low-odor formula that provides long-lasting flexibility and excellent adhesion to ensure a protective barrier against moisture and mildew. It provides a watertight seal around kitchen and bath fixtures and cures to an ultra smooth, satin finish. Interior use. Solvent clean up.



- 0836 - 10.1 Fl. Oz. (300 mL) - White
- 0836/20 - 10.1 Fl. Oz. (300 mL) - Almond
- 0883 - 2.8 Fl. Oz. (83 mL) - White
- 0885 - 2.8 Fl. Oz. (83 mL) - Clear
- 0887 - 10.1 Fl. Oz. (300 mL) - Clear

Meets or exceeds performance requirements of Fed. Spec. TT-S-00230C, TT-S-001543A, ASTM C920 and FDA Reg. No. 21 CFR 177, 2600 when fully cured. UL Recognized.

## DURAGUARD™ KITCHEN & BATH SILICONIZED ACRYLIC CAULK

Odorless, mildew-resistant formula fortified with silicone to provide a long-lasting, water-tight seal around tubs, showers, sinks and fixtures. Interior use. Water clean up.



- 0405 - 5.5 Fl. Oz. (160 mL) - White
- 0405/20 - 5.5 Fl. Oz. (160 mL) - Almond
- 0406 - 10.1 Fl. Oz. (300 mL) - White
- 0406/20 - 10.1 Fl. Oz. (300 mL) - Almond
- 0408 - 10.1 Fl. Oz. (300 mL) - Clear
- 0445 - 5.5 Fl. Oz. (160 mL) - Clear

## EZ SQUEEZE® KITCHEN & BATH CAULK

Made especially for kitchen and bath areas where a water-resistant, mildew-proof seal is required, this siliconized acrylic sealant provides a tight seal around sinks, showers, bathtubs and countertops and cures to an ultra smooth, satin finish. Mildew-proof, odorless, dries quickly and cleans up with water. The patented EZ SQUEEZE® Device allows you to wind up the tube as you work, ensuring a steady supply of product that comes out smoothly and easily down to the last drop.



- 0838 - 5 Fl. Oz. (150 mL) - White

## CAULK STRIPS

Self-adhesive decorative trim is pre-shaped for fast, easy installation. It provides a long-lasting seal and gives a finished professional look to kitchen and bath areas. Best of all, the mildew-resistant caulk strip installs in minutes – simply peel and press in place. No tools or messy clean up!

### Tub & Wall Caulk Strip

For use between bathtub and wall.

- 0150 - 7/8" x 11' - White
- 0151 - 1 5/8" x 11' - White



### Tub & Floor Caulk Strip

For use between bathtub and floor.

- 0170 - 1 1/2" x 5' - White



### Wall & Counter Caulk Strip

For use between walls and countertop.

- 0155 - 1" x 12' - White



### Fixture Caulk Strip

For use around toilets, sinks and showers.

- 0152 - 1/2" x 6' - White



# Industrial/Contractor

## 100% SILICONE SEALANT INDUSTRIAL GRADE RTV

High performance sealing and glazing compound that is ideal for use in most OEM and maintenance applications. Forms a strong, durable and weather-resistant seal and provides excellent adhesion to most non-porous surfaces. 50 year warranty. Solvent clean up. NSF listed.



- 0816/0I - 10.1 Fl. Oz. (300 mL) - White
- 0816/2I - 10.1 Fl. Oz. (300 mL) - Almond
- 0816/4I - 10.1 Fl. Oz. (300 mL) - Bronze
- 0816/5I - 10.1 Fl. Oz. (300 mL) - Gray
- 0816/6I - 10.1 Fl. Oz. (300 mL) - Black
- 0826/0I - 10.1 Fl. Oz. (300 mL) - Clear

Meets or exceeds the requirements of TT-S-00230C, TT-S-001543A, C.G.S.B. 19C9-9, Din 18540 Part 2, Mil. Spec 46106A, CEBTP 432.65 140-2, ASTM C920. USDA authorized for use in federally inspected meat and poultry plants.



## NOISE PROOF™ ACOUSTIC SEALANT

Noise Proof™ Acoustic Sealant is a water-based, acrylic latex sealant that reduces sound transmission while sealing joints. It can be applied to all openings and areas where sound transmission may occur. It has a long-lasting, permanently flexible bond. Low VOC and low odor.

- 0586 - 10.1 Fl. Oz. (300 mL) - White
- 0589 - 28 Fl. Oz. (858 mL) - White

Meets or exceeds Federal Specifications ASTM-E90, ASTM-E84, ASTM-C834.



## R5™ WINDOW & DOOR ACRYLIC CAULK

R5™ Window & Door Siliconized Acrylic Caulk provides extra tight seals around windows, doors and other areas. This multi-purpose, paintable sealant can be used indoors or outdoors and helps increase energy efficiency by resisting thermal temperature changes and reducing drafts and cold spots. It also provides a barrier to the entry of dirt, insects and other pests.

- 0656 - 10.1 Fl. Oz. (300 mL)



## SILICONIZED ACRYLIC CAULK CONSTRUCTION GRADE - 35 YEAR

Superior sealant fortified with silicone for increased flexibility and extended life. It provides excellent adhesion to most interior and exterior surfaces. Mildew resistant, low odor and low VOC. 35 year warranty. Water clean up.

- 0846/0I - 10.1 Fl. Oz. (300 mL) - White
- 0846/2I - 10.1 Fl. Oz. (300 mL) - Almond
- 0846/4I - 10.1 Fl. Oz. (300 mL) - Brown
- 0846/5I - 10.1 Fl. Oz. (300 mL) - Gray
- 0846/6I - 10.1 Fl. Oz. (300 mL) - Black
- 0876/0I - 10.1 Fl. Oz. (300 mL) - Clear

Meets or exceeds the requirements of ASTM C834.



## BUTYL RUBBER SEALANT ARCHITECTURAL GRADE

A high-performance, rubber-like sealant that is ideal for tough outdoor jobs and below-grade applications. Use indoors or out, wherever a durable, flexible and watertight seal is required. Butyl rubber sealant adheres to most building surfaces and remains rubbery and flexible. Paintable. 10 year warranty.

- 0697/0I - 10.1 Fl. Oz. (300 mL) - White
- 0697/GI - 10.1 Fl. Oz. (300 mL) - Gray

Meets or exceeds the requirements of Federal Specifications TT-S-001657, TT-C-00598C, TT-C-1796A.



## 100% SILICONE SEALANT HEAT RESISTANT RTV

Formulated with iron oxide to resist extreme heat exposure. Withstands temperatures up to 600°F and can be used on industrial ovens, heating elements, boilers, and more. 50 year warranty. Solvent clean up.

- 0809/0I - 10.1 Fl. Oz. (300 mL) - Red
- 0829/0I - 2.8 Fl. Oz. (183 mL) - Red

Meets or exceeds the requirements of TT-S-00230C, TT-S-001543A, C.G.S.B. 19C9-9, Din 18540 Part 2, Mil. Spec 46106A, CEBTP 432.65 140-2, ASTM C920. USDA authorized for use in federally inspected meat and poultry plants.







® The Red Devil Industrial line of sealants are high performance, superior sealants specifically designed for the professional contractor. These industrial grade sealants provide excellent adhesion and durability for any professional job.

### EXTREME TEMPERATURE HVAC/R SILICONE SEALANT

Made especially for HVAC/R applications, this premium sealant provides a long-lasting, weather-resistant seal and offers excellent adhesion, flexibility and durability. Use on air conditioners, ducts, furnaces, water heaters, refrigerators, vents and more. Adheres well to metal and most other building materials and remains flexible from - 60°F to 500°F.



- 0896 - 10.1 Fl. Oz. (300 mL) - White
- 0896/50 - 10.1 Fl. Oz. (300 mL) - Aluminum
- 0897 - 10.1 Fl. Oz. (300 mL) - Clear

Meets or exceeds Federal Specifications  
TT-S-00230C, Class A, TT-S-001543A Class A, ASTM C920.

### WATER-BASED DUCT SEALANT

A gray water-based duct sealant used in medium and high-pressure duct systems. It is a special formulation which is non-flammable and provides permanent flexibility, excellent water-resistance and superior sealing strength. Use to seal metal to metal joints to prevent air leaks in medium and high pressure systems of spiral and rectangular ductwork for refrigeration, air-conditioning, ventilation and air distribution. May also be used to seal joints on run-outs of connecting metal flexible tubing.

- 0846DI - 10.1 Fl. Oz. (300 mL)
- 0841DI - 1 Gallon (3.79 L)



### CELULON® ADHESIVE SEALANT SPEC 230 FORMULA

A water-resistant adhesive that exhibits strength, durability and adhesive characteristics superior to silicone in most adhesion tests with the added benefits of paintability, ease of application and low odor. 50 year warranty. Water clean up.

- 0926/OI - 10.1 Fl. Oz. (300 mL) - White
- 0927/OI - 10.1 Fl. Oz. (300 mL) - Clear

Meets or exceeds the requirements of Federal Specifications TT-S-00230C, ASTM C920, and ASTM C834.



### SILICONIZED ACRYLIC CAULK NEW CONSTRUCTION GRADE - 40 YEAR

Durable, multi-purpose caulk for the professional contractor. Provides excellent adhesion, remains flexible and forms a weather-proof seal. Specially formulated to resist paint film cracking, it is vacuumized for smooth and easy application without "afterflow", spurts or pops. Cured bead is mildew resistant. 40 year warranty. Water clean up.

- 0906/OI - 10.1 Fl. Oz. (300 mL) - White
- Meets or exceeds the requirements of ASTM C834.



### FIRESTOP LC150RD SEALANT

A latex-based, high-solids firestop compound that effectively seals penetration openings against the spread of fire, smoke, toxic gases and water when applied properly. Endothermic fillers absorb heat and release water and the high solids formula means no shrinkage. Withstands temperatures up to 1000°F and is up to 2 hour fire rated. Sandable and paintable. Water clean up.

- LC150RD - 9.0 Fl. Oz. (266 mL) - Red

Meets Fed. Specs. ASTM E-814 (UL 1479) and ASTM E-84 (UL 723) and many UL classifications.



# Construction Adhesives

## GENERAL PURPOSE CONSTRUCTION ADHESIVE

General Purpose Construction Adhesive is a professional-strength, VOC-compliant formula that exceeds performance requirements of ASTM-557. It contains no ozone depleting chemicals and is ideal for stone, marble, hardboard, gypsum wallboard, slate, ceramic tile, polyurethane and polystyrene foams.

0776/06 - 9.0 Fl. Oz. (266 mL) - White

0779 - 28 Fl. Oz. (858 mL) - White

Meets or exceeds the performance requirements of ASTM C-557.



## HEAVY DUTY CONSTRUCTION ADHESIVE

A specially formulated heavy duty construction adhesive designed for interior and exterior use. Used for remodeling repair projects as well as for general construction. This low VOC, eco-friendly formula bonds to a wide range of the heaviest construction materials. Its superior bond strength often eliminates the need for nails and screws.

0692- 10.1 Fl. Oz. (300 mL) - White

0892 - 28 Fl. Oz. (858 mL) - White

Meets or exceeds the requirements of Federal Specifications ASTM C-557.



## COVE BASE CONSTRUCTION ADHESIVE

Powerful premium-quality construction adhesive formulated for rapid installation of vinyl or rubber cove base to most interior wall surfaces. Low VOC, eco-friendly formula with easy water clean up. It has quick initial tack with no bracing required and is designed to bond cove base and stair treads.

0693 - 10.1 Fl. Oz. (300 mL) - White

0893 - 28 Fl. Oz. (858 mL) - White



## PANEL & FOAM CONSTRUCTION ADHESIVE

A top quality, VOC-compliant construction adhesive for bonding, paneling and foamboard. Provides an impact-resistant bond and is ideal for wood, hardboard, gypsum wallboard, ceramic tile, polyurethane and polystyrene foams.

0694 - 10.1 Fl. Oz. (300 mL) - White

0894 - 28 Fl. Oz. (858 mL) - White



## QUICK GRIP™ CONSTRUCTION ADHESIVE

Powerful premium quality, all-purpose construction adhesive with a quick setting instant grab that holds like an iron grip! Low VOC, eco-friendly formula with easy water clean up.

0696 - 9.0 Fl. Oz. (266 mL)

Meets or exceeds the performance requirements of ASTM C-557 and AFG-01.





## DRYWALL CONSTRUCTION ADHESIVE

A specially formulated, VOC-compliant adhesive used for adhering drywall to structurally sound surfaces. Best suited for bonding gypsum drywall to metal and wood studs.

0899 - 28 Fl. Oz. (858 mL)

Meets or exceeds the performance requirements of ASTM C-557.



## SUBFLOOR & DECK CONSTRUCTION ADHESIVE

Subfloor & Deck Adhesive is a premium quality construction adhesive designed for subfloor construction reducing nailing requirements and nail pops. Low VOC, eco-friendly formula with easy water clean up. It is ideal for plywood, treated and untreated lumber, particle board, drywall, masonry and plaster.

0690 - 10.1 Fl. Oz. (300 mL) - White

0890 - 28 Fl. Oz. (858 mL) - White

Meets or exceeds the performance requirements of AFG-01.

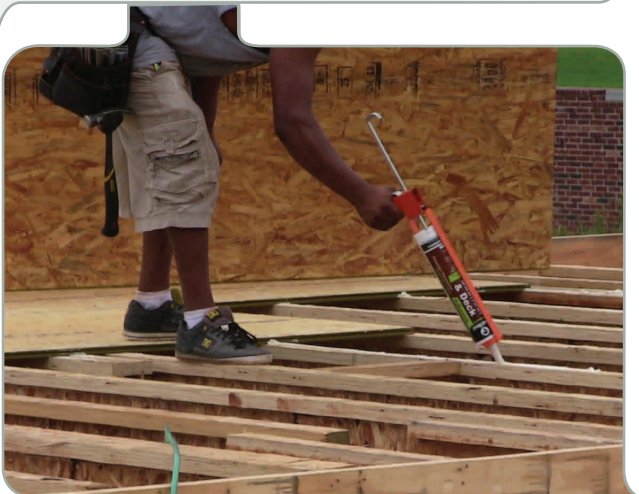

## Powerful • Permanent CONSTRUCTION Adhesive

Red Devil's water-based adhesive line is GREENGUARD® approved! GREENGUARD® certification differentiates products through independent, third-party evaluations.

GEI's standards are rooted in solid science and supported by comprehensive, state of the art laboratory testing and data analysis. In addition, GREENGUARD® Certified products are referenced in, recognized or preferred by sustainable building programs, government agencies, standards, specifications, codes, companies and institutions around the world.

- U.S. Green Building Council's (USGBC) LEED® Green Building Rating System
- Collaborative for High Performance Schools
- The National Association of Home Builders ICC700-2008 National Green Building Standard
- Green Globes
- ASHRAE 189.1
- International Green Construction Code (IgCC)



# Specialty Products

## TRIPLE EXPANDING FOAM

Foam & Fill® Triple Expanding Polyurethane Sealant is quick and easy to use. It expands to fill large holes, cracks, gaps and voids around windows, doors, pipes, outlets, vents and foundations – indoors or outdoors. This insulating foam forms an airtight, waterproof bond and seals out drafts, moisture and pests. Cured foam can be sanded, painted or stained.

0909 - 12 Oz. (340 g)

0912 - 20 Oz. (568 g)



## MINIMAL EXPANDING FOAM

Foam & Fill® Minimal Expanding foam seals, bonds, and insulates, filling small holes in ceilings, floorboards, concrete or cinder block walls, and around ducts, cables, plumbing areas, and central heating pipes. Use indoors or outdoors.

0913 - 12 Oz. (340 g)

0920 - 20 Oz. (568 g)



## WINDOW & DOOR POLYURETHANE FOAM

Window and Door Polyurethane Straw Foam is specifically formulated for filling, insulating and sealing around windows and doors. Innovative low pressure and expansion formula eliminates the chance of bowing and provides a full cavity fill. Takes the shape of all cavities forming a permanent, airtight and waterproof seal on wood, metal, masonry, glass and most plastics. It stops air infiltration and in turn prevents heat loss and drafts. It is environmentally safe, contains no CFCs and HCFCs. It is UL listed and an AAMA Verified Component.

0914 - 12 Oz. (340 g)



## FIRE BLOCK POLYURETHANE FOAM

Fire Block is a ready to use polyurethane expanding foam for filling, insulating and sealing gaps, cracks and openings in buildings' interior and exterior. It inhibits the passage of fire through residential utility penetrations and is excellent in sealing against gas, smoke and energy loss.

0915 - 12 Oz. (340 g)

Evaluated Per ICC-ESR-3402 and tested according to ASTM E 814 NFPA 286.





## POLYURETHANE WINDOW & DOOR

A premium grade, high performance sealant, designed specifically for installing or repairing door and window frames and sealing all types of siding. It provides superior adhesion to most building materials and is excellent for sealing out the elements and increasing energy efficiency. Paintable and non-staining. 50 year limited warranty. Interior/exterior use. Solvent clean up.

0970 - 10.1 Fl. Oz. (300 mL) - White

Meets requirements of Fed. Spec. TT-S-00230C and ASTM C920.



## POLYURETHANE MASONRY & CONCRETE

A premium grade, high performance sealant, designed to meet the flexibility requirements of dynamically moving joints. Specially textured to simulate concrete, it provides excellent weatherability, adhesion and fast cure time with high bonding strength. Paintable and non-staining. 50 year limited warranty. Interior/exterior use. Solvent clean up.

0972 - 10.1 Fl. Oz. (300 mL) - Limestone

Meets requirements of Fed. Spec. TT-S-00230C and ASTM C920.



## POLYURETHANE BLACKTOP & ROOF

A premium grade, high-performance sealant that provides a long-lasting seal with excellent adhesion. Because of its strong resistance to deterioration, it has an extended life expectancy and helps prevent ice and water damage caused by severe weather. 50 year limited warranty. Exterior use. Solvent clean up.

0971 - 10.1 Fl. Oz. (300 mL) - Black

Meets requirements of Fed. Spec. TT-S-00230C and ASTM C920.



## CLEAR CAULK HIGH PERFORMANCE ADHESIVE

A high-performance adhesive sealant that applies and dries ultra clear and offers excellent adhesion to most surfaces. Can be applied in below freezing temperatures and above or below grade. Won't yellow, stain, crack or separate once cured. Remains flexible. Paintable. 50 year limited warranty. Interior/exterior use. Solvent clean up.

0870 - 10.1 Fl. Oz. (300 mL)

0871 - 5.5 Fl. Oz. (160 mL)



## GLAZING PRODUCTS

Whether you prefer the classic Window Glazing putty or the water-based formula, Red Devil® has everything needed for replacing panes of glass.

### GLAZING COMPOUND

Siliconized acrylic formula creates a durable, watertight seal for the installation of glass into sash. Cartridge with easy applicator tip provides excellent results. Water-based.

0666 - 10.1 Fl. Oz. (300 mL) - White



### PRE-MIXED GLAZING COMPOUND

Contractor specified formula for installing glass in wood or metal sashes. Forms airtight and watertight seal. Takes any paint. Oil-based.

0662 - 1/2 Pint (.24 liter)

0664 - 1 Quart (.96 liter)



### ZIP-A-WAY® REMOVABLE SEALANT

Specially formulated weatherstripping caulk forms a tight, temporary seal that can easily be peeled away when no longer needed. It is easy to apply and provides a watertight and weatherproof seal that prevents drafts and moisture. Will not mar or destroy most painted surfaces. Interior/exterior.

0606 - 10.1 Fl. Oz. (300 mL) - Clear



# Specialty Products

## MASONRY & CONCRETE REPAIR

Ideal for patching cracks in steps and sidewalks or repairing mortar between bricks, stone, and cinder block. Textured finish blends with mortar and provides excellent outdoor durability. Exterior use. Water clean up.

0646 - 10.1 Fl. Oz. (300 mL) - Gray

## BLACKTOP & ROOF REPAIR

Asphalt sealant that provides a durable, flexible and weather-resistant seal for cracks and joints in asphalt driveways. Also ideal for waterproofing, repairing and sealing roofs, shingles and flashings around chimneys and skylights. Can be used on wet or dry surfaces. Exterior use. Solvent clean up.

0636 - 10.1 Fl. Oz. (300 mL) - Black

## BLACKTOP REPAIR

Acrylic asphalt sealant that provides a durable, flexible and weather-resistant seal for cracks and joints in asphalt driveways, parking lots and more. It provides excellent adhesion and prevents water and frost damage.

0637 - 10.1 Fl. Oz. (300 mL) - Black

## GUTTER & FOUNDATION SEALANT

Butyl rubber sealant ideal for outdoor jobs requiring a durable, watertight seal. Use around concrete foundations and expansion joints, around gutters and in below-grade areas such as basements. Adheres to most construction surfaces and remains flexible. Exterior use. Solvent clean up.

0697 - 10.1 Fl. Oz. (300 mL) - White

0697/AG - 10.1 Fl. Oz. (300 mL) - Gray

Meets or exceeds the following specifications: Fed. Spec. TT-S-001657, Type I; Fed. Spec. TT-C-1796A, Type I; TT-C-598C, Type I.

## FIREPLACE & STOVE REPAIR

Super-tough, silicate cement sets rock-hard when fired. The black, textured paste adheres well to fire brick, cinder block, metal and mortar. It cures with a warm fire and provides a durable, long-lasting seal that withstands temperatures up to 1000° F. Non-flammable. Interior use. Water clean up.

0466 - 10.1 Fl. Oz. (300 mL) - Black





# RD3000™

## RD3000™ ALL PURPOSE SEALANT

An advanced, low-VOC, all-purpose sealant with a specially formulated technology allowing it to be exposed to water after only 2 hours without washing out. Also formulated with advanced MaxFlex Technology™ – It won't crack or shrink and provides excellent adhesion, flexibility and durability for a waterproof seal. Cured sealant is mold and mildew resistant.

0986 - 9.0 Fl. Oz. (266 mL) - White

0987 - 9.0 Fl. Oz. (266 mL) - Clear

Meets or exceeds performance requirements of Fed Spec TT-S-00230C Class A & ASTM C920 Class 25.



## RD3000™ KITCHEN & BATH SEALANT

An advanced, low-VOC, kitchen & bath sealant with a specially formulated technology allowing it to be exposed to water after only 2 hours without washing out. Also formulated with advanced MaxFlex Technology™ – It won't crack or shrink and provides excellent adhesion, flexibility and durability for a waterproof seal. Cured sealant is mold and mildew resistant.

0996 - 9.0 Fl. Oz. (266 mL) - White

0997 - 9.0 Fl. Oz. (266 mL) - Clear

Meets or exceeds performance requirements of Fed Spec TT-S-00230C Class A & ASTM C920 Class 25.



Red Devil's RD3000™ Line of Advanced Polymer Sealants are specially formulated with MaxFlex™ Technology for excellent adhesion and flexibility. They offer a lifetime durability guarantee and are water resistant after 2 hours. These high quality sealants are perfect for any home improvement or professional job.

- **Won't Shrink Or Crack**
- **Low-VOC**
- **Paintable**
- **900% Elongation**
- **Mold And Mildew Resistant**

## RD3000™ SELF LEVELING CONCRETE SEALANT

An advanced, low VOC, self-leveling concrete sealant designed to offer superior adhesion to concrete as well as a wide variety of substrates with a smooth finish, which allows installation without tooling. It contains a specially formulated technology allowing it to be exposed to water after only 2 hours without washing out. Won't crack or shrink and provides excellent adhesion, flexibility and durability for a waterproof seal.

0980 - 9.0 Fl. Oz. (266 mL) - Gray



## RD3000™ GUTTER & FLASHING SEALANT

An advanced, low-VOC, gutter and flashing sealant with a specially formulated technology allowing it to be exposed to water after only 2 hours without washing out. Also formulated with advanced MaxFlex Technology™ – It won't crack or shrink & provides excellent adhesion, flexibility and durability for a waterproof seal.

0990 - 9.0 Fl. Oz. (266 mL) - White

Meets or exceeds ASTM C920 requirements.



# Create-A-Color®

The CREATE-A-COLOR® Caulk Coloring System is a simple and easy way to create custom-colored caulk in minutes. This unique system allows on-the-job coloring of a single tube of caulk using ordinary latex paint. Watch the color change right before your eyes – the results are amazing!

A must-have system for painters, decorators, contractors, till installers, masons, plumbers, wallpaper hangers, and even homeowners, this innovative system allows you to match your caulk with fixtures, countertops, tile, walls, wallpaper and more.

## CAULK MIXERS

This unique product tints a single tube of CREATE-A-COLOR® Caulk with ordinary latex paint. Portable and convenient, it is simple to use and cleans easily with soap and water. Includes syringe for extracting paint and easy-to-follow instruction guide.

4071 - Pro Caulk Mixer\* Die-cast Aluminum



4070 - Standard Caulk Mixer\* Sturdy Plastic



### KIT INCLUDES:

- 2 Tubes of Create-A-Color Caulk
- Standard Caulk Mixer
- Syringe

4074 - Create-A-Color Kit

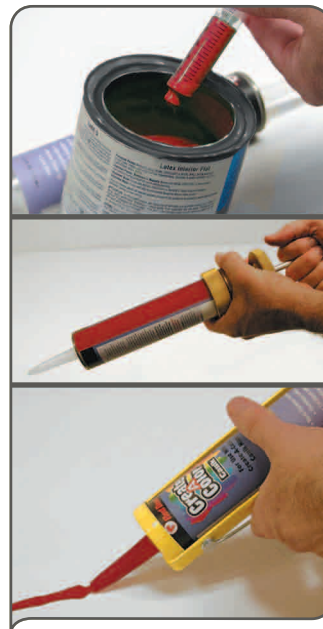

Paint must be purchased separately.



## CREATE-A-COLOR® CAULK

Specially formulated to be tinted using a CREATE-A-COLOR® Caulk Mixer, this superior quality sealant offers excellent adhesion to most surfaces. It provides a long-lasting, mildew-resistant seal that cures to an ultra-smooth, satin finish. Interior/exterior. Odorless. Water clean-up.

0409 - 9.4 Fl. Oz. (278 mL)

## SYRINGES

25 replacement syringes for CREATE-A-COLOR® Caulk System.

4072 - Pack of 25



\*The CREATE-A-COLOR® Caulk Mixer is designed for use exclusively with CREATE-A-COLOR® Caulk from Red Devil, Inc.



# Tile Products

## PRE-MIXED TILE GROUT, PASTE

Water-resistant compound grouts all ceramic and mosaic tile. Formulated with premium acrylic latex for fast, easy-to-use application.

0420 - 2.25 Fl. Oz. (.66 cc)

0422 - 1/2 Pint (.24 liter)

0424 - 1 Quart (.96 liter)

0425 - 5.5 Fl. Oz. (160 mL)

0428 - 1 Pint (.48 liter)



## EZ SQUEEZE® TILE GROUT

Water-resistant compound for repairing loose, cracked or damaged grout in ceramic and mosaic tile. The patented EZ SQUEEZE® Device allows you to wind up the tube as you work, ensuring a steady supply of product that comes out smoothly and easily down to the last drop.

0438 - 5 FL. Oz. ( 150 mL)



## TILE PASTE ADHESIVE

Perfect for installing and repairing mosaic, plastic and ceramic tile, and linoleum. Water clean up.

0497 - 5.5 Fl. Oz. (160 mL)



## EZ SQUEEZE® TILE ADHESIVE

A premium sealant for installing or replacing loose tile or linoleum. It provides a permanent bond between tile and surface and cleans easily with water. The patented EZ SQUEEZE® Device allows you to wind up the tube as you work, ensuring a steady supply of product that comes out smoothly and easily down to the last drop.

0498 - 5 Fl. Oz. (150 mL)



# Patch and Repair Products

A quality line of patch and repair products for hundreds of interior and exterior repair jobs. Fill cracks in drywall or plaster, repair nail hole or texturize paint to hide minor flaws.

## ONETIME® LIGHTWEIGHT SPACKLING

Pre-mixed formula for fast, professional repairs in just one application. Use to fill cracks, nail holes, and other holes in plaster, wallboard, wood and stucco. Won't shrink, crack or sag. No sanding required. Interior exterior. Water clean up.

- 0541 - 1 Gallon (3.79 liter)
- 0542 - 1/2 Pint (.24 liter)
- 0544 - 1 Quart (.96 liter)
- 0545 - 6 Fl. Oz. (178 mL)
- 0548 - 1 Pint (.48 liter)



## ONETIME® LIGHTEN UP™ LIGHTWEIGHT SPACKLING

This lightweight, color-change formula goes on pink, but dries white when it's time to paint. Pre-mixed formula for fast, professional repairs in just one application. Use to fill cracks, nail holes, and other holes in plaster, wallboard, wood and stucco. Won't shrink, crack or flake. No sanding required. Interior/exterior. Water clean up.

- 0572 - 1/2 Pint (.24 liter)
- 0574 - 1 Quart (.96 liter)
- 0575 - 5 Fl. Oz. (150 mL)



## CRACK PATCH™ PREMIUM SPACKLING

Crack Patch™ Spackling provides superior performance for filling dents, holes & cracks in surfaces such as drywall, plaster, wood, stucco, brick and stone. This pre-mixed formula spreads easily for fast, professional repairs to walls and ceilings and will not crumble or flake when used as directed.

- 0801 - 1 Gallon (3.79 liter)
- 0802 - 1/2 Pint (.24 liter)
- 0804 - 1 Quart (.96 liter)
- 0805 - 5.5 Fl. Oz. (160 mL)



## ONETIME® PATCH & PRIME™ LIGHTWEIGHT SPACKLING

Spackling and primer in one! This premium, lightweight, pre-mixed spackling saves time with no need to prime before painting. It fills holes in one application with no shrinking or cracking.

- 0540 - 1 Pint (.48 liter)



Patch & Repair Products



## ONETIME® WALL REPAIR PATCH

See page 34 of the Tools catalog 1218





## PRE-MIXED STUCCO WALL PATCH

Red Devil Stucco Wall Patch is a pre-mixed ready to use stucco patch for the repair of small holes and cracks in interior and exterior stucco surfaces. This professional, sanded formula blends naturally with existing stucco.

0450 - 1 Quart (.96 liter)

0451 - 1 Gallon (3.79 liter)



## PRE-MIXED JOINT COMPOUND

Ready-to-use formula for finishing and repairing drywall panel joints. Formulated to work with joint tape and ideal for metal corner beads, nail heads, and repairs to drywall. Sands easily. Water clean up.

0744 - 1 Quart (.95 liter)



## VINYL SPACKLING COMPOUND

Patches holes and nail holes quickly and easily. Specially formulated for easy application, paintability, and sanding. Use indoors or out on plaster, wallboard, wood and stucco.

0531 - 1 Gallon (3.79 liter)

0532 - 1/2 Pint (.24 liter)

0534 - 1 Quart (.95 liter)

0538 - 1 Pint (.48 liter)

0615 - 5.5 Fl. Oz. (160 mL)



## PRE-MIXED CONCRETE PATCH

Red Devil Concrete Patch is a pre-mixed, ready-to-use concrete patch for the repair of holes, cracks, breaks and other imperfections in concrete or masonry surfaces. Not recommended for areas subject to vehicular traffic.

0641 - 1 Gallon (3.79 liter)

0644 - 1 Quart (.96 liter)

0645 - 5.5 Fl. Oz. (160 mL)



## EZ SQUEEZE® WALLPAPER SEAM REPAIR

The easiest solution for repairing torn or peeling wallpaper, this premium adhesive provides a strong final bond between surface and wallpaper and prevents peeling in high-humidity areas such as kitchens and baths. Excellent adhesion, odorless, easy water clean up. The patented EZ SQUEEZE® Device allows you to wind up the tube as you work, ensuring a steady supply of product that comes out smoothly and easily – every time – down to the last drop.

0878 - 5 Fl. Oz. (150 mL) - Clear



## PATCH-A-WALL® SPACKLING PASTE

Patches holes quickly and easily. Specially formulated for easy application, paintability, and sanding. Use on plaster, wallboard, wood and stucco. The patented EZ SQUEEZE® Device allows you to wind up the tube as you work, ensuring a steady supply of product that comes out smoothly and easily – every time – down to the last drop.

0658 - 5 Fl. Oz. (150 mL)



# Cleaning and Maintenance

## SAV-A-BRUSH® BRUSH RESTORER, POWDER

Paint brush restorer gives new life to old brushes, cleaning paint-hardened brushes right down to the heel.

0103 - 3 Oz. (85 g)



## TSP-90® HEAVY DUTY CLEANER

A tri-sodium phosphate substitute that neutralizes and floats away grease, grime, dirt, oil and smoke film. Contains no phosphorous, soap, lye, or abrasives. Packaged in a re-sealable bag.

0261 - 1 Lb. (.45 kg)

0265 - 4 Lb. (1.81 kg)

Note: Gloves recommended. Do not use on glass.

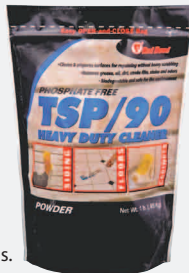

## TACK CLOTH

Specially treated cotton fiber cloth is perfect for eliminating dust, lint, and sanded particles on all surfaces. Prepares surface for painting.

0570 - 18" x 36"

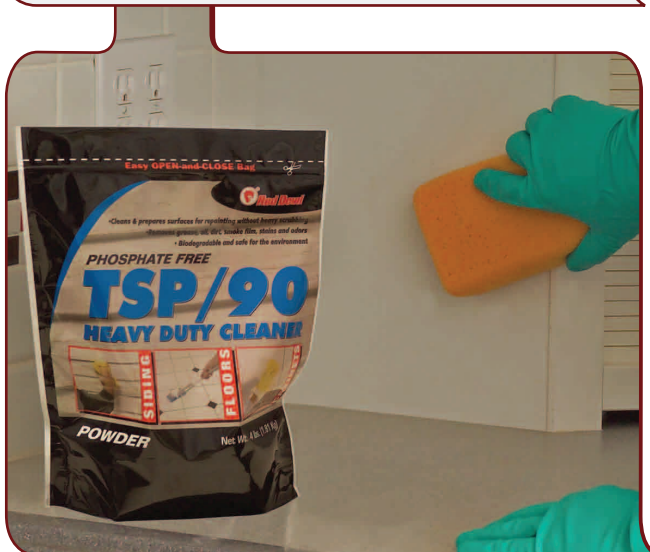



## Alphabetical Index

PRODUCT	PAGE #
100% Silicone Sealant	3
Blacktop & Roof Repair	14
Blacktop Repair Acrylic Asphalt Sealant	14
Caulk Strips	7
Clear High Performance Caulk	13
ColorCure® Advanced Sealant	2
Concrete Patch, Pre-Mixed	19
Construction Adhesives	10
Crack Patch™ Premium Spackling	18
Create-A-Color® Caulk	16
Create-A-Color® Kit	16
Create-A-Color® Pro Mixer	16
Create-A-Color® Standard Mixer	16
Create-A-Color® Syringes	16
Duct Sealant	9
DuraGuard™ Kitchen & Bath Sealants	7
EZ SQUEEZE® Kitchen & Bath Caulk	7
EZ SQUEEZE® Tile Adhesive	17
EZ SQUEEZE® Tile Grout	17
EZ SQUEEZE® Wallpaper Seam Repair	19
EZ SQUEEZE® Window & Door Caulk	5
Fireplace & Stove Repair	14
Firestop LC150RD Sealant	9
Foam & Fill™ Expanding Foam	12
Glazing Compounds	13
Gutter & Foundation Sealant	14
HVAC/R Silicone Sealant	9
Joint Compound, Pre-Mixed	19
King Kaulk®	4
Kitchen & Bath Low Odor Silicone Sealant	7
Kitchen & Bath w/ Stain Block™ Sealants	6
LIFETIME® Adhesive Sealant	5
LIFETIME® Window, Door & Trim Sealant	3
LIFETIME® Ultra Premium Sealants	3
LIGHTEN UP™ Color Change Spackling	18
Masonry & Concrete Repair	14
Noise Proof Acoustical Sealant	8
ONETIME® Lightweight Spackling	18
ONETIME® Patch & Prime Spackling	18
Painter's Caulk	4
PATCH-A-WALL® Spackling Paste	19
Polyurethane Blacktop & Roof	13
Polyurethane Masonry & Concrete	13
Polyurethane Window & Door	13
Pre-Mixed Tile Grout Paste	17
QuickPaint® Caulk	4
R5 Window & Door Acrylic Caulk	8
RD3000™ Self-Leveling Concrete	15
RD3000™ All-Purpose Sealant	15
RD3000™ Gutter & Flashing	15

PRODUCT	PAGE #
RD3000™ Kitchen & Bath Sealant	15
RD PRO® Butyl Rubber	8
RD PRO® Celulon® Adhesive	9
RD PRO® Heat Resistant Silicone	8
RD PRO® Siliconized Acrylic Construction Grade	9
RD PRO® 100% Silicone Sealant	8
SAV-A-BRUSH® Brush Restorer	20
Silicone Shield Kitchen & Bath Sealant	6
SPEED DEMON® Acrylic Caulk	4
Stucco Wall Patch, Pre-Mixed	19
Tack Cloth	20
Tile Grout, Pre-Mixed	17
TILE PASTE Adhesive	17
TSP-90® Heavy Duty Cleaner	20
Vinyl Spackling Compound	19
Window & Door Caulk	5
ZIP-A-WAY® Removable Sealant	13

## Product Number Index

ITEM #	PRODUCT DESCRIPTION	PAGE #
0103	SAV-A-BRUSH®, 3 Oz.	20
0150	Caulk Strip-Tub & Wall	7
0151	Caulk Strip-Tub & Floor	7
0152	Caulk Strip-Fixture	7
0155	Caulk Strip-Wall & Counter	7
0170	Caulk Strip-Tub & Wall	7
0261	TSP-90® Cleaner, 1 Lb.	20
0265	TSP-90® Cleaner, 4 Lb.	20
0405	DuraGuard® Kitchen & Bath Caulk, White 5.5 FL. Oz.	7
0405/20	DuraGuard® Kitchen & Bath Caulk, Almond 5.5 FL. Oz.	7
0406	DuraGuard® Kitchen & Bath Caulk, White 10.1 FL. Oz.	7
0406/20	DuraGuard® Kitchen & Bath Caulk, Almond 10.1 FL. Oz.	7
0408	DuraGuard® Kitchen & Bath Caulk, Clear 10.1 FL. Oz.	7
0409	CREATE-A-COLOR™ Caulk	16
0420	Pre-Mixed Tile Grout, 2.25 Oz.	17
0422	Pre-Mixed Tile Grout, .5 Pt.	17
0424	Pre-Mixed Tile Grout, 1 Qt.	17
0425	Pre-Mixed Tile Grout, 5.5 FL. Oz.	17
0428	Pre-Mixed Tile Grout, 1 Pt.	17
0438	EZ SQUEEZE® Tile Grout, 5 FL. Oz.	17
0445	DuraGuard® Kitchen & Bath Caulk, Clear, 5.5 FL. Oz.	7
0450	Stucco Wall Patch, 1 Qt.	19
0451	Stucco Wall Patch, 1 Gallon	19
0466	Fireplace & Stove Repair	14
0497	Tile Paste Adhesive	17

## Product Number Index

ITEM #	PRODUCT DESCRIPTION	PAGE #	ITEM #	PRODUCT DESCRIPTION	PAGE #
0498	EZ SQUEEZE® Tile Adhesive, 5 Fl. Oz.	17	0770/60	LIFETIME® Ultra Sealant, Black, 10.1 Fl. Oz.	3
0531	Vinyl Spackling Compound, 1 Gallon	19	0775	LIFETIME® Ultra Sealant, White, 5.5 Fl. Oz.	3
0532	Vinyl Spackling Compound, .5 Pt.	19	0777	LIFETIME® Ultra Sealant, Clear, 10.1 Fl. Oz.	3
0534	Vinyl Spackling Compound, 1 Qt.	19	0776/06	General Purpose Const. Adhesive, 9 Fl. Oz.	10
0538	Vinyl Spackling Compound, 1 Pt.	19	0779	General Purpose Const. Adhesive, 28 Fl. Oz.	10
0540	ONETIME® Patch & Prime™, 1 Pt.	18	0801	Crack Patch™ Premium Spackling, 1 Gallon	18
0541	ONETIME® Spackling, 1 Gallon	18	0802	Crack Patch™ Premium Spackling, .5 Pt.	18
0542	ONETIME® Spackling, .5 Pt.	18	0804	Crack Patch™ Premium Spackling, 1 Qt.	18
0544	ONETIME® Spackling, 1 Qt.	18	0805	Crack Patch™ Premium Spackling, 5.5 Fl. Oz.	18
0545	ONETIME® Spackling, 6 Fl. Oz.	18	0809/0I	RD PRO® Heat Resist. Silicone, Red, 10.1 Fl. Oz.	8
0548	ONETIME® Spackling 1 Pt.	18	0810	100% Silicone Sealant, White, 2.8 Fl. Oz.	3
0570	Tack Cloth	20	0816	100% Silicone Sealant, White, 10.1 Fl. Oz.	3
0572	ONETIME® Lighten-Up Spackling, .5 Pt	18	0816/40	100% Silicone Sealant, Bronze, 10.1 Fl. Oz.	3
0574	ONETIME® Lighten-Up Spackling, 1 Qt.	18	0816/50	100% Silicone Sealant, Gray, 10.1 Fl. Oz.	3
0575	ONETIME® Lighten-Up Spackling, 5.0 Fl. Oz.	18	0816/60	100% Silicone Sealant, Black, 10.1 Fl. Oz.	3
0576	ColorCure® Advanced Sealant, 10.1 Fl. Oz.	2	0816/0I	RD PRO® 100% RTV Silicone, White	8
0585	ColorCure® Advanced Sealant, 5.0 Fl. Oz.	2	0816/2I	RD PRO® 100% RTV Silicone, Almond	8
0586	Noise Proof Acoustical Sealant, 10.1 Fl. Oz.	8	0816/4I	RD PRO® 100% RTV Silicone, Bronze	8
0589	Noise Proof Acoustical Sealant, 28 Fl. Oz.	8	0816/5I	RD PRO® 100% RTV Silicone, Gray	8
0606	ZIP-A-WAY® Removable Sealant	13	0816/6I	RD PRO® 100% RTV Silicone, Black	8
0615	Vinyl Spackling Compound, 5.5 Fl. Oz.	19	0816KB	Silicone Shield Kitchen & Bath, White	6
0636	Blacktop & Roof Repair	14	0820	100% Silicone Sealant, Clear, 2.8 Fl. Oz.	3
0637	Blacktop Repair Acrylic Sealant	14	0826	100% Silicone Sealant, Clear, 10.1 Fl. Oz.	3
0641	Concrete Patch, 1 Gallon	19	0826KB	Silicone Shield Kitchen & Bath, Clear	6
0644	Concrete Patch, 1 Qt.	19	0826/0I	RD PRO® 100% RTV Silicone, Clear	8
0645	Concrete Patch, 5.5 Fl. Oz.	19	0829/0I	RD PRO® Heat Resist. Silicone, Red, 2.8 Fl. Oz.	8
0646	Concrete & Mortar Repair	14	0836	Kitchen & Bath 100% Silicone, White, 10.1 Oz.	7
0656	R5 Window & Door Acrylic Caulk, 10.1 Fl. Oz.	8	0836/20	Kitchen & Bath 100% Silicone, Almond, 10.1 Oz.	7
0658	EZ SQUEEZE® Patch-A-Wall®, 5 Fl. Oz.	17	0838	EZ SQUEEZE® Kitchen & Bath Caulk, 5 Fl. Oz.	7
0662	Glazing Compound, .5 Pt.	13	0846DI	Water-Based Duct Sealant, 10.1 Fl. Oz.	9
0664	Glazing Compound, 1 Qt.	13	0851DI	Water-Based Duct Sealant, 1 Gallon	9
0666	Glazing Compound, 10.1 FL. Oz.	13	0846	Window & Door Acrylic Caulk, White	5
0690	Subfloor & Deck Const. Adhesive, 10.1 Fl. Oz.	11	0846/0I	RD PRO® Const. Grade Caulk 35 Yr., White	8
0692	Heavy Duty Const. Adhesive, 10.1 Fl. Oz.	10	0846/20	Window & Door Acrylic Caulk, Almond	5
0693	Cove Base Construction Adhesive, 10.1 Fl. Oz.	10	0846/2I	RD PRO® Const. Grade Caulk 35 Yr., Almond	8
0694	Panel & Foam Const. Adhesive, 10.1 Fl. Oz.	10	0846/30	Window & Door Acrylic Caulk, Cedar	5
0696	Quick Grip Adhesive	10	0846/40	Window & Door Acrylic Caulk, Dark Brown	5
0697	Gutter & Foundation, White	14	0846/4I	RD PRO® Const. Grade Caulk 35 Yr., Bronze	8
0697/AG	Gutter & Foundation, Aluminum Gray	14	0846/50	Window & Door Acrylic Caulk, Gray	5
0697/0I	RD PRO® Butyl Rubber, White	8	0846/5I	RD PRO® Const. Grade Caulk 35 Yr., Gray	8
0697/GI	RD PRO® Butyl Rubber, Gray	8	0846/60	Window & Door Acrylic Caulk, Black	5
0736	SPEED DEMON® Acrylic Caulk, White	4	0846/6I	RD PRO® Const. Grade Caulk 35 Yr., Black	8
0744	Joint Compound, 1 Qt.	19	0848	EZ SQUEEZE® Window & Door Caulk, White	5
0746	Painters Caulk	4	0855	LIFETIME® Adhesive Sealant, White, 5.5 Fl. Oz.	5
0750	Kitchen & Bath Stain Block, White, 10.1 Oz.	6	0856	LIFETIME® Adhesive Sealant, White, 10.1 Fl. Oz.	5
0750/22	Kitchen & Bath Stain Block, Biscuit, 10.1 Fl. Oz.	6	0856/20	LIFETIME® Adhesive Sealant, Almond, 10.1 Oz.	5
0755	Kitchen & Bath Stain Block, White, 5.5 Fl. Oz.	6	0856/30	LIFETIME® Adhesive Sealant, Cedar, 10.1 Fl. Oz.	5
0755/22	Kitchen & Bath Stain Block, Biscuit, 5.5 Fl. Oz.	6	0856/40	LIFETIME® Adhesive Sealant, Dk Brown, 10.1 Oz.	5
0757	Kitchen & Bath Stain Block, Clear, 10.1 Fl. Oz.	6	0856/50	LIFETIME® Adhesive Sealant, Gray, 10.1 Fl. Oz.	5
0765	Kitchen & Bath Stain Block, Clear, 5.5 Fl. Oz.	6	0856/60	LIFETIME® Adhesive Sealant, Black, 10.1 Fl. Oz.	5
0770	LIFETIME® Ultra Sealant, White, 10.1 Fl. Oz.	3	0856PR	LIFETIME® Window, Door & Trim, White	3
0770/10	LIFETIME® Ultra Sealant, Tan, 10.1 Fl. Oz.	3	0865	LIFETIME® Adhesive Sealant, Clear, 5.5 Fl. Oz.	5
0770/20	LIFETIME® Ultra Sealant, Almond, 10.1 Fl. Oz.	3	0866	LIFETIME® Adhesive Sealant, Clear, 10.1 Fl. Oz.	5
0770/40	LIFETIME® Ultra Sealant, Brown, 10.1 Fl. Oz.	3	0866PR	LIFETIME® Window, Door & Trim, Clear	3
0770/50	LIFETIME® Ultra Sealant, Gray, 10.1 Fl. Oz.	3	0870	Clear Caulk, 10.1 Fl. Oz.	13



## Product Number Index

ITEM #	PRODUCT DESCRIPTION	PAGE #
0871	Clear Caulk, 5.5 Fl. Oz.	13
0876	Window & Door Acrylic Caulk, Clear	5
0876/01	RD PRO® Const. Grade Caulk 35 Yr., Clear	8
0878	EZ SQUEEZE® Wallpaper Seam Repair, 5 Fl. Oz.	19
0883	Kitchen & Bath 100% Silicone, White, 2.8 Fl. Oz.	7
0885	Kitchen & Bath 100% Silicone, Clear, 2.8 Fl. Oz.	7
0887	Kitchen & Bath 100% Silicone, Clear, 10.1 Fl. Oz.	7
0890	Subfloor & Deck Const. Adhesive, 28 Fl. Oz.	11
0892	Heavy Duty Const. Adhesive, 28 Fl. Oz.	10
0893	Cove Base Construction Adhesive, 28 Fl. Oz.	10
0894	Panel & Foam Const. Adhesive, 28 Fl. Oz.	10
0896	HVAC/R Silicone Sealant, White	9
0896/50	HVAC/R Silicone Sealant, Aluminum	9
0897	HVAC/R Silicone Sealant, Clear	9
0899	Drywall Construction Adhesive, 28 Fl. Oz.	11
0906/01	RD PRO® Construction Grade Caulk 40 Yr., White	9
0909	Triple Expanding Foam, 12 Oz.	12
0912	Triple Expanding Foam, 24 Oz.	12
0913	Minimal Expanding Foam, 12 Oz.	12
0920	Minimal Expanding Foam, 20 Oz.	12
092601	RD PRO® SPEC 230 Celulon®, White	9
092701	RD PRO® SPEC 230 Celulon®, Clear	9
0946	QUICK PAINT® Acrylic Caulk	4
0956	KING KAULK® Hybrid Polymer, White, 9.8 Fl. Oz.	4
0966	KING KAULK® Hybrid Polymer, Clear, 9.8 Fl. Oz.	4
0970	Polyurethane Window & Door	13
0971	Polyurethane Blacktop & Roof	13
0972	Polyurethane Masonry & Concrete	13
0980	RD3000™ Self Leveling Concrete Sealant	15
0986	RD3000™ All Purpose Sealant, White	15
0987	RD3000™ All Purpose Sealant, Clear	15
0990	RD3000™ Gutter & Flashing Sealant	15
0996	RD3000™ Kitchen & Bath Sealant, White	15
0997	RD3000™ Kitchen & Bath Sealant, Clear	15
LC150RD	Firestop Latex Sealant	9
4070	Create-A-Color® Standard Caulk Mixer	16
4071	Create-A-Color® Pro Caulk Mixer	16
4072	Bag of Syringes, 25 pack	16
4074	Create-A-Color® Kit	16

Powerful • Permanent  
**CONSTRUCTION**  
**Adhesive**



**1 ONETIME®**  
**PATCH & PRIME**  
Lightweight Spackling



**LIFETIME**

**FOAM  
& FILL®**

**COLORCURE®**  
PINK 2 WHITE

**CRACK  
PATCH**

**RD PRO®**

**KING  
KAULK®**

**ONETIME®** 

**RD3000™**

The following is a partial list of registered trademarks and/or trade names of Red Devil, Inc.:

CAULK DEVIL®, CELULON® Adhesive Sealant, CRACK PATCH™, CREATE-A-COLOR® Caulk, CREATE-A-COLOR® Caulk Mixers, EZ SQUEEZE® Squeeze Tubes, EZ CAULK® Tub & Tile, FOAM & FILL® Expanding Foam, HOUSE & HOME RESTORE® Squeeze Tubes, KING KAULK® Hybrid Polymer, LIFETIME® Brand Adhesive Sealant, LIGHTEN UP™ Lightweight Spackling, ONETIME® Lighten Up™ Patch & Repair, ONETIME® Patch & Prime™ Spackling, ONETIME® Spackling, PATCH-A-WALL®, QUICKpaint® Caulk, RD PRO®, RD3000™, Red Devil® Caulks & Sealants, SAV-A-BRUSH® Brush Restorer, SILICONE SHIELD™ Sealant, SPEED DEMON® Caulk, SPEED DEMON® Paint Mixer, TSP-90® Cleaner, ZIP-A-WAY™ Removable Caulk





***Red Devil***

**Manufacturing Facilities  
& Customer Service**

---

**4175 Webb Street**

**Pryor, OK 74361**

**Customer Service: 1-800-423-3845**

**Fax: 918-825-5761**

**Corporate Office**

---

**1437 S. Boulder Avenue, Suite 750**

**Tulsa, OK 74119**

**Phone: 918-585-8111**

**Fax: 918-585-8120**

**Visit us at:**

**[www.reddevil.com](http://www.reddevil.com)**



***Red Devil***

Red Devil, Inc. • 4175 Webb Street • Pryor, OK 74361  
Customer Service: 1-800-423-3845 • Fax: (918) 825-5761